

*Auxiliary workstation for
robotic storage & retrieval
in retail pharmacies*

- Fits into existing pharmacy workflow patterns and floor plans
- Automates daily put away process
- Increased inventory turns with less on hand inventory
- Virtually eliminates waste
- Remote Stock Management— includes all items in inventory not stored in the RxSafe system (i.e. refrigerator)
- Real-time accuracy to the pill or package (minimizes manual auditing)
- Real-time tracking of every operator interaction
- Expiration date and lot number tracking
- Biometric login required for medication access
- Utilizes EyeCon® automated pill counter (optional)

The RxAWS™ complements the RxSafe 1800™ and RxSafe 900™ by adding a one or more workstations for checking in inventory, putting away remote stock, and filling prescriptions from remote stock. Additionally, all of the standard features of the RxSafe system, including reports, can be accessed from the RxAWS.

The RxAWS is designed to manage open stock inventory with or without the RxSafe tower system.



Phone: 877.797.2332
Email: info@rxsafe.com
www.rxsafe.com

800 N. Twin Oaks Valley Road, Suite 101
San Marcos, CA 92069

Specifications for RxAWS™ System

- Dimensions W=24" L=18" H=18"
- Weight 10 lbs.
- Capacity Unlimited
- Script Fill Rate Up to 60 per hour with single operator
- Communications Ethernet connection
- Workstation Touch screen monitor, biometric fingerprint reader, integrated barcode scanner, barcode label printer, keyboard, mouse, automated serial number tag feeder, EyeCon® automated tablet counter (optional)
- Software Proprietary RxSafe software and firmware

RxAWS Field Performance Data

- Cost Reduction 30% less on-hand inventory
Avoids waste due to expired drugs
Millions of prescriptions filled with unparalleled accuracy

Custom Pharmacy Layout Services

- Workflow Optimization Integrates RxSafe automation into existing pharmacy space

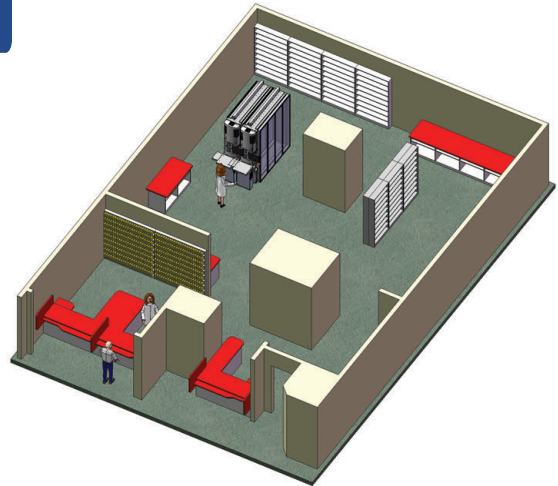

Phone: 877.797.2332
Email: info@rxsafe.com
www.rxsafe.com

800 N. Twin Oaks Valley Road, Suite 101
San Marcos, CA 92069

Revised 11.17.14