

# RxAWS™ Auxiliary Workstation for Robotic Storage & Retrieval in Retail Pharmacies

**Included with the purchase of an RxSafe 1800.**



The RxAWS (Auxiliary Workstation) complements the RxSafe 1800™ and RxSafe 900™ by adding one or more workstations for checking in inventory, putting away remote stock, and filling prescriptions from remote stock. Additionally, all of the standard features of the RxSafe system, including reports, can be accessed from the RxAWS.

The RxAWS is designed to manage open stock inventory with or without the RxSafe tower system.

### Included With an RxSafe 1800 System

Many pharmacies' workflow requires concurrent tasks like checking in inventory, filling prescriptions, and accessing reports for things to run smoothly and efficiently. Since the RxAWS now comes bundled with an RxSafe 1800, these activities can be accomplished simultaneously without disruption.



Accuracy & Speed



Space Savings



Narcotics Security



Inventory Management

- Fits into existing pharmacy workflow patterns and floor plans
- Automates daily put away process
- Increased inventory turns with less on hand inventory
- Virtually eliminates waste
- Remote Stock Management—includes all items in inventory not stored in the RxSafe system (i.e. refrigerator)
- Real-time accuracy to the pill or package (minimizes manual auditing)
- Real-time tracking of every operator interaction
- Expiration date and lot number tracking
- Biometric login required for medication access
- Utilizes Eyecon® automated pill counter (optional)



Phone: 877.797.2332  
Email: info@rxsafe.com  
www.rxsafe.com

2453 Cades Way, Suite A  
Vista, CA 92081

## Specifications for RxAWS™ System

- Dimensions W=24" L=18" H=18"
- Weight 10 lbs.
- Capacity Unlimited
- Script Fill Rate Up to 60 per hour with single operator
- Communications Ethernet connection
- Workstation Touch screen monitor, biometric fingerprint reader, integrated barcode scanner, barcode label printer, keyboard, mouse, automated serial number tag feeder, EyeCon® automated tablet counter (optional)
- Software Proprietary RxSafe software and firmware

## RxAWS Field Performance Data

- Cost Reduction 30% less on-hand inventory  
Avoids waste due to expired drugs  
Millions of prescriptions filled with unparalleled accuracy

## Custom Pharmacy Layout Services

- Workflow Optimization Integrates RxSafe automation into existing pharmacy space

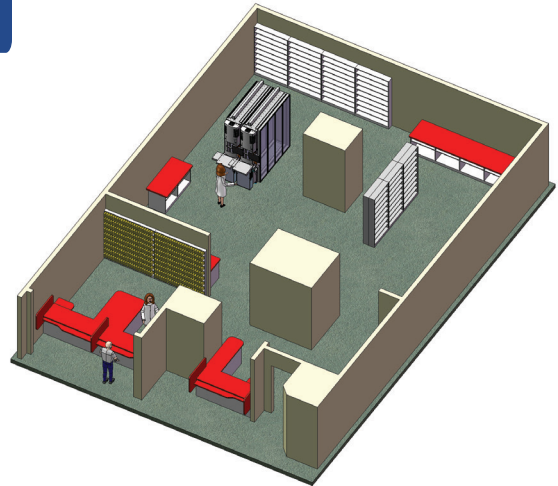

Phone: 877.797.2332  
Email: [info@rxsafe.com](mailto:info@rxsafe.com)  
[www.rxsafe.com](http://www.rxsafe.com)

2453 Cades Way, Suite A  
Vista, CA 92081

Revised 02.08.18